

Introduction

Welcome to the Beechmere Retirement Living construction newsletter from Eric Wright Construction.

Eric Wright Construction has been appointed by Avantage to start enabling works on the site of the former Beechmere building, and this will begin on 13 February 2023.

As we move forward, further updates will follow but we would like to take this opportunity to assure you that we always try to keep disturbances to the local community to a minimum. However, there will be some noise disruption from time to time.

[Dave Watson](#) is the Project Manager.

Architect's impression of the building



Key Dates

Site establishment and
tree/shrub removal:

13 February

Demolition commencement –
Hard surfacing and concrete slab
breaking up:

March 22

Project Description

Eric Wright Construction has currently been appointed as Principal Contractor to continue to carry out the design work, and complete the enabling works (ground works) of the Beechmere re-build. The overall build contract is still out to tender but will involve building a c.132 apartment building for people aged 55 plus, in the same footprint as the original building.

Planned works over the coming month

Site establishment works will start with the installation of temporary welfare cabins and the clearance of shrubs and trees around the perimeter. The installation of perimeter fencing and replacement of existing fencing will follow soon after.

The demolition contractor will begin breaking up the concrete slabs at the beginning of March. A process that is expected to take approximately seven weeks.

Questions & Answers

Will there be any noisy periods?

Yes, however the works will be kept within the agreed time periods in line with local planning restrictions. Where possible we will use the quietest plant and equipment available and utilise sound muffling techniques to reduce noise.

How will any wind blown dust be dealt with?

We are committed to keeping our site as clean and dust free as possible. During the demolition, the dust will be controlled via the use of water suppression whilst the areas of the building are demolished.

Will there be any problems with mud on the road?

Eric Wright Group Ltd will ensure that the working machinery, plant & vehicles, which may have the potential to cause an excessive dust or mud problem onto the public highway, will have the facility to wash down. This will be placed at a strategic point near to the road exit of the site, to prevent the mud being carried on to the road. If the road does get muddy, a road sweeper will be used to clean it.

For more information on Eric Wright
Construction please visit:
www.ericwright.co.uk

Outline Information

Client:	Avantage
Architect:	Lovelock Mitchell Architects
Structural Engineer:	Hydrock
Mechanical and Electrical Engineer:	Futureserv

Site Logistics Plan

Below is a plan of the proposed construction site phases.

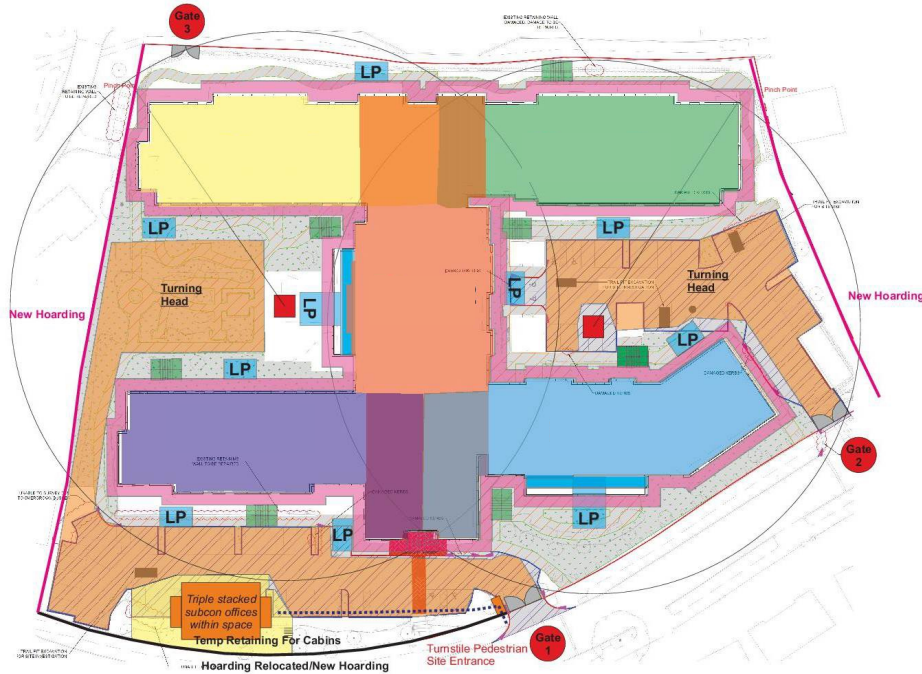

ERIC WRIGHT
CONSTRUCTION

Eric Wright Construction Ltd
Surrey House, 40-42 Old
Beche Road, Finchley N11 6NY
Tel: 020 8822 2222
Fax: 020 8822 2222
www.ericwright.co.uk

Beechmere Extracare Development, Crewe
Draft Site : **Draft Logistics**

Code of Considerate Practice

The Considerate Constructors Scheme is the national initiative set up by the construction industry to improve its image.

Companies registered with the Scheme are monitored against a Code of Considerate Practice, designed to encourage best practice beyond statutory requirements. As associate members of the Considerate Constructors scheme we are committed to ensuring our sites comply with the following:

✓ **Care about Appearance**

Constructors should ensure sites appear professional and well managed

✓ **Respect the Community**

Constructors should give utmost consideration to their impact on neighbours and the public

✓ **Protect the Environment**

Constructors should protect and enhance the environment

✓ **Secure Everyone's Safety**

Constructors should attain the highest levels of safety performance

✓ **Value their Workforce**

Constructors should provide a supportive and caring working environment



Working in Crewe

Eric Wright Construction have committed to using local labour and materials where possible while undertaking these works.

Site Contact Details

Any feedback, suggestions or concerns can be directed to our Operations Manager allocated to this project,

T: 07917 574049

E: mrogerson@ericwright.co.uk

If you would like to receive electronic versions of future newsletters, please contact us on the email address above.

Please follow us on:

